

LIGHT FOR HOTEL AND WELLNESS

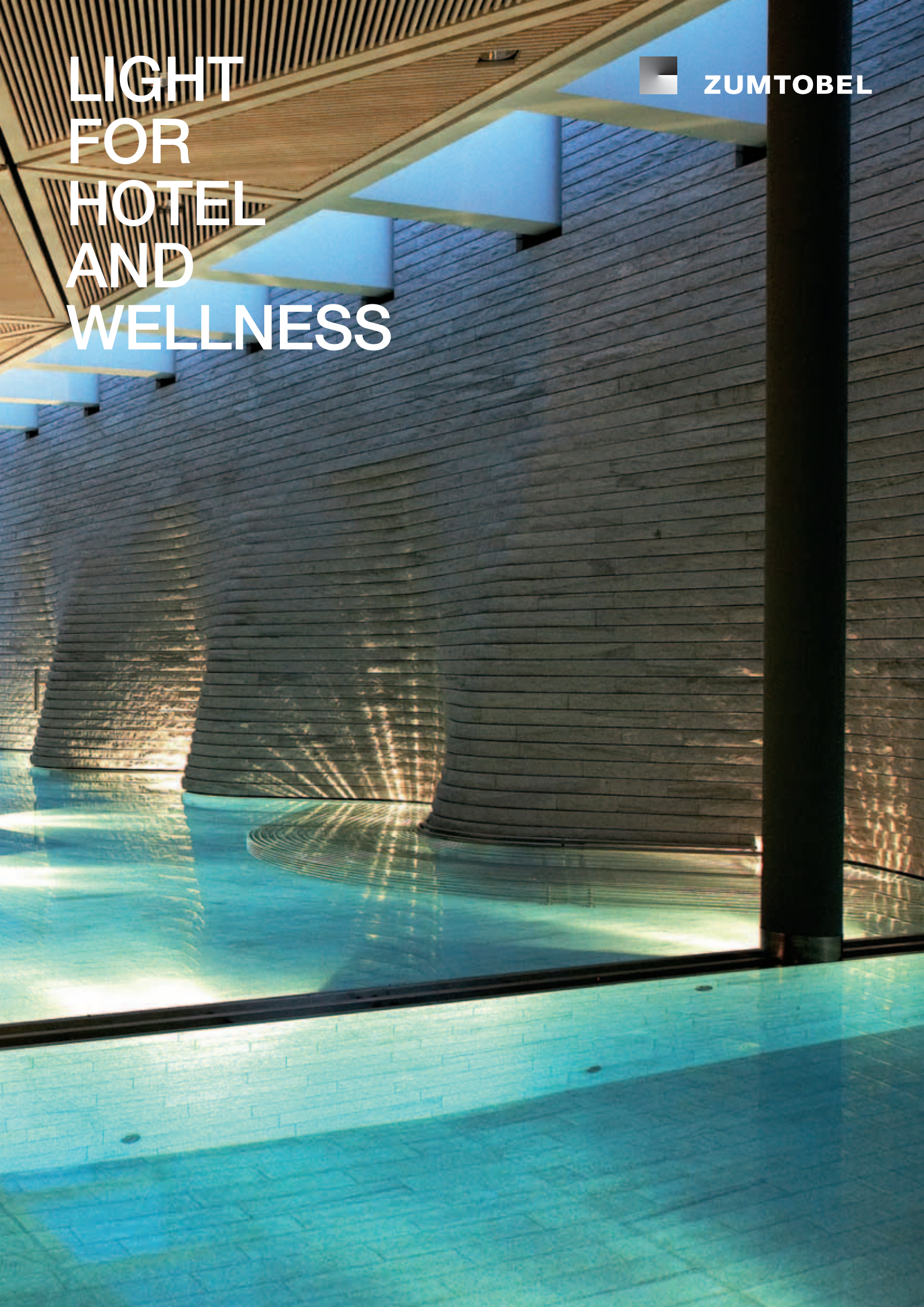

ZUMTOBEL



HUMANERGY BALANCE

Lighting solutions for
the balance between
environment, energy
and the individual.

Lighting quality Hotel and Wellness

A lighting concept which is geared towards the guest
provides an atmosphere in a hotel room
Various lighting scenes with a feel-good factor bolster the
guest's body clock
An emotionally captivating lighting atmosphere transforms
a stay into an experience

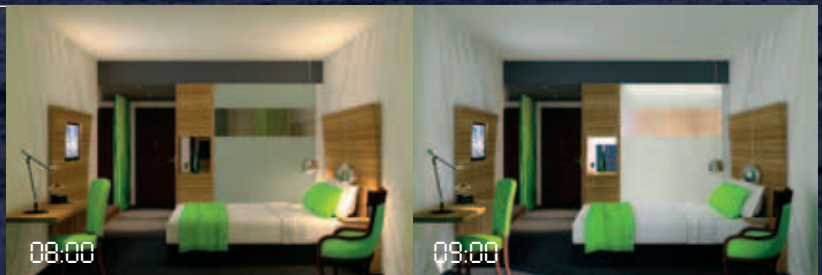

Good morning: the day gets started with
pleasant room brightening.

Refreshing: in bathrooms, the focus is on
feeling good and visual recognition.



Hotel and Wellness Energy efficiency

Intelligent control systems exploit the potential to save energy, e.g. through preset reduced brightness levels and lighting scenes which are individually adapted to suit a particular activity

Multifunctional, zoned lighting concepts and sophisticated LED solutions boost efficiency still further



14:00

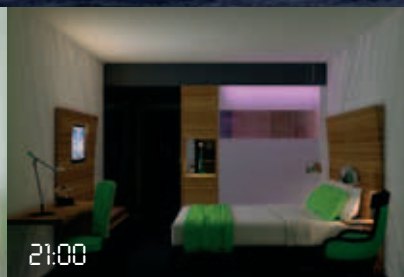

21:00

First impressions count: pleasant room lighting is inviting for guests.

Relaxing: indirect light components make people relax.

ELI
Ergonomic Lighting
Indicator



LENI
Lighting Energy
Numeric Indicator



Lighting quality assessed on the basis of five criteria:
A Visual performance
B Vista
C Visual comfort
D Vitality
E Empowerment

Energy consumption in kWh per annum and per square metre, based on EN 15193.

HOTEL KRONE, DORNBIRN/A
AUSTRIA TREND HOTEL SAVOYEN, VIENNA/A
BERGOASE TSCHUGGEN AROSA/CH
CARLTON HOTEL, ST. MORITZ/CH
CROWNE PLAZA HOTEL, GENEVA/CH
DOM HOTEL, LINZ/A
EAST HOTEL, HAMBURG/D

LIGHT FOR HOTEL AND WELLNESS

A good hotel is a temporary home from home. It conveys a feeling of wellbeing and is characterised by a special air of hospitality. The design of the rooms and their materials, colours and light all make a decisive contribution towards achieving this effect.

Light which welcomes guests, light that can be adjusted to suit guests' preferences and moods at the press of a button and leaves a lasting impression.

Light like this conveys esteem, as well as, helping save energy and thus being gentle on the environment.

Lighting solutions which define a hotel concept make it easier for operators to stand out from the competition.

REFERENCE LIST

EMIRATES PALACE, ABU DHABI/UAE
FOUR SEASONS, MOSCOW/RUS
GOLDEN TULIP HOTEL, VEIJLE/DK
GRAND HOTEL ESPLANADE, BERLIN/D
GRAND RESORT, BAD RAGAZ/CH
HOTEL AURELIO, LECH/A
HOTEL AQUALIS WELLNESS, SPA/B
HOTEL BLEIBERGER HOF, BAD BLEIBERG/A
HOTEL BUDERSAND, SYLT/D
HOTEL CASAL DEL MARMO, ROME/I
HOTEL CASINO FLAMINO, GEVGELIJA/MK
HOTEL CLARION, STOCKHOLM/S
HOTEL DU CADRAN, PARIS/F
HOTEL EMPIRE RIVERSIDE, HAMBURG/D
HOTEL EUROPA, MINSK/BELARUS
HOTEL HILTON, DUSSELDORF/D
HOTEL HILTON AIRPORT, ZURICH/CH
HOTEL INTERCONTINENTAL, GENEVA/CH
HOTEL JUNGBRUNN, TANNHEIMER TAL/A
HOTEL KRONE, DORNBIRN/A
HOTEL LEFAY RESORT AND SPA, LAKE GARDA/I
HOTEL MAMA SHELTER, PARIS/F
HOTEL PIRITA TOP SPA, TALLINN/EST
HOTEL PUERTA AMERICA, MADRID/E
HOTEL SAN BIAGIO, PISA/I
HOTEL SELENE, ROME/I
HOTEL SONNE, MELLAU/A
HOTEL THERME VALS, VALS/CH
ISHTAR DEAD SEA RESORT HOTEL, AMMAN/HKJ
MARITIM AIRPORT HOTEL, DUSSELDORF/D
MARITIM KONGRESSHOTEL, BERLIN/D
MÖVENPICK AIRPORT HOTEL, STUTTGART/D
MÖVENPICK HOTEL, BEIRUT/RL
MÖVENPICK HOTEL, LAUSANNE/CH
NH HOTEL, MILAN/I
NOVOTEL, BOLOGNA/I
NOVOTEL, LINZ/A
RADISSON SAS AIRPORT HOTEL, ZURICH/CH
RADISSON SAS BLUE HEAVEN, FRANKFURT/D
RADISSON SAS HOTEL (DOMAQUAREE), BERLIN/D
RADISSON SAS HOTEL TWEETORENWIJK, HASSELT/NL
RADISSON SAS HOTEL, ST. GALLEN/CH
RIDERS PALACE, LAAX/CH
ROOMERS, FRANKFURT/D
SHERATON HOTEL, SOPOT/PL
SIDE HOTEL, HAMBURG/D
SOFITEL, CAIRO/ET
STEIGENBERGER AIRPORT HOTEL, FRANKFURT/D
STEIGENBERGER AVANCE HOTEL, KREMS/A
STEIGENBERGER HOTEL, MERANO/I
TERME DI MERANO, MERANO/I
THE GROVE TAVERN, BELFAST/IRL
VIGIL ILLIS MOUNTAIN RESORT, I ANA/I



KHAN SAHIB RESTAURANT | Manchester / GB



HOTEL PUERTO AMERICA | Madrid / E

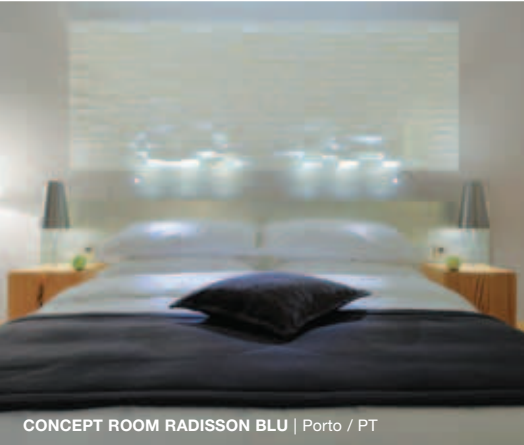

CONCEPT ROOM RADISSON BLU | Porto / PT



HOTEL THERME MERAN | Merano / I



HOTEL DU CADRAN | Paris / F



AQUALIS | Spa / B



LEFAY RESORT | Lake Garda / I



SIDE HOTEL | Hamburg / D



DAVID 38 | St. Gallen / CH

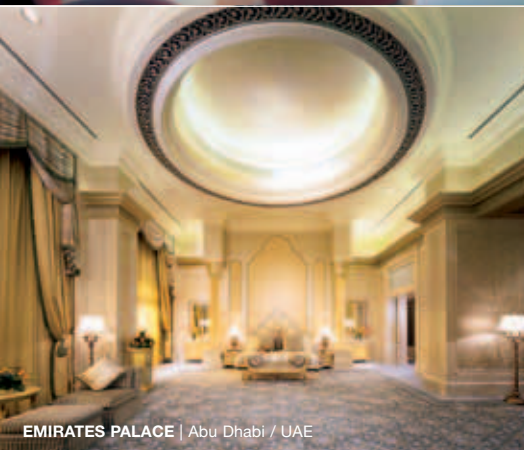

EMIRATES PALACE | Abu Dhabi / UAE



HOTEL SONNE | Mellau / A

Trends	Identifying trends	8
	Implementing trends	10
<hr/>		
A tour round the hotel	Perfect light in every area	12
<hr/>		
Feeling light	Hotel room and suite	14
	Private spa areas	18
	Entrance and reception areas	20
<hr/>		
Experiencing light	Wellness and relaxation oases	22
	Dining areas	28
<hr/>		
Seeing light	Multifunctional rooms	32
	Corridors and functional areas	36
	Circulation routes and technical equipment rooms	38
	Facades and outdoor areas	40
<hr/>		
LEDs for Hotel and Wellness	Energy efficient for more than 50,000 hours	42
<hr/>		
Emergency lighting	ONLITE emergency lighting for hotels	44
<hr/>		
Lighting management	DIMLITE, EMOTION, ZBOX and LITENET	46
<hr/>		
Examples of lighting solutions	Possible implementations and suggested products	48

Identifying trends

New directions in the hotel business



New technologies and design Being reachable 24/7 and having easy access to new media are taken for granted nowadays. This is why technology interfaces including, the iPod generation and WLAN Internet access, have become standard facilities in the premium hotel segment – as have an intuitively operated lighting management system and dynamic LED lighting solutions.



Globalisation Business travellers in a globalised world expect a modern, cosmopolitan atmosphere which is familiar to them but which nevertheless features some regional characteristics. Internationalisation is leading to ever greater fusion of typical national stylistic elements – especially those from the Asia-Pacific region – in guest rooms, themed restaurants and spa areas.

Responsibility When it comes to dealing with resource responsibly, hotel guests expectations are constantly rising. New hotel concepts are deliberately backing regenerative energy sources and environmentally benign operating methods. The lighting in a hotel must also emphasise these values. Energy-efficient light sources and advanced lighting control systems offer enormous potential energy savings combined with improved operating convenience.



Spa and wellness Relaxing in a challenging world is becoming an important part of a positive attitude towards life. The trend towards prevention rather than cure in exclusively equipped settings demonstrates clients' greater awareness of quality. Whether in a medical spa or a private spa, guests are willing to make greater provision for preventative measures to safeguard their health.



Implementing trends

Zumtobel offers solutions



New technologies and design Zumtobel products embody an accomplished blend of innovative lighting technology and trendsetting design. Ongoing product development secures our leading role when it comes to striking an optimum balance between luminaires and lighting control in order to produce high-quality, energy-optimised lighting solutions.



Globalisation With 50 own sales organisations and commercial agencies in a total of 70 countries, Zumtobel shows international presence at the customer's site. Our corporate values include global planning, regional implementation and adaptation to meet national specifications, on-site services and cultural competence. Customers who operate internationally, in particular, reap the benefits of this competence.

Responsibility Conserving resources is one of Zumtobel's core concerns. Improving the efficiency of luminaires by deploying new technologies and coatings, and production based on a certified environmental management system are all important components of our integrated corporate strategy. In future, greater importance will be attached to lighting control, in particular, because it offers huge energy-saving potential.



Spa and wellness Zumtobel has been conducting research on the biological and emotional effects of light on individuals in scientific studies and projects for several years. Knowledge concerning the effect of light on both body and mind can be utilised in light therapy, thereby promoting the harmonious design of chill-out areas.



A tour round the hotel

Perfect light in every area

FEELING LIGHT

LOBBY AND HOTEL ROOM Reception acts as a hotel's business card. This is where hotel guests find their bearings and where they want to experience friendly sincerity and a feeling of security. A hotel room is a temporary home from home for guests. They want to feel welcome, relax and be able to seclude themselves in privacy. Thanks to flexible, intuitively controlled lighting options, guests can create their own feel-good atmosphere.

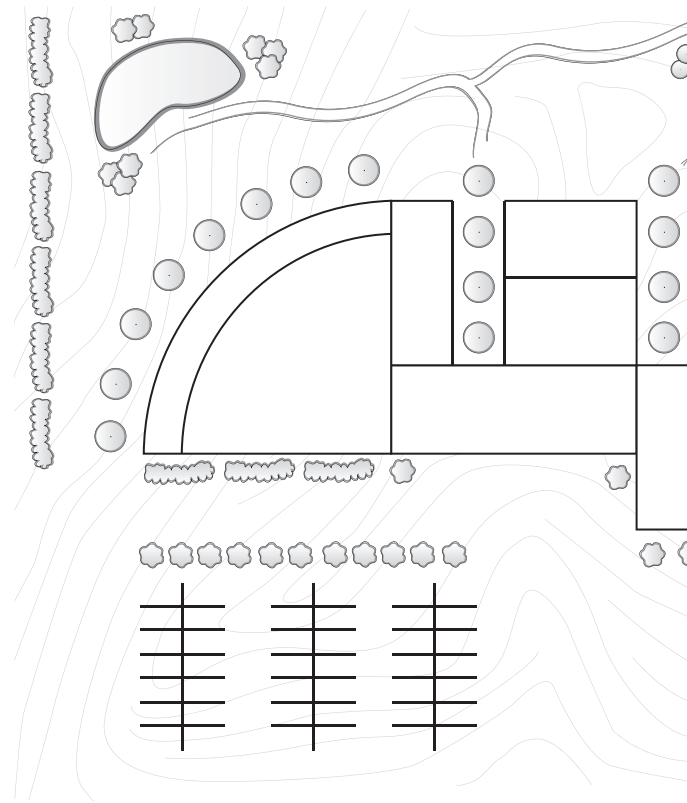

The hotel as a stage – light for setting the scene A harmonious transition between feel-good areas and themed areas offers guests a welcome change and provides an element of the unexpected. Rather like a good play in which the story unfolds slowly and climaxes at a key moment, the hotel guest makes his or her logical way around individual areas, from the lobby, through corridors, to the room, to the meeting room and from the bar to the spa area. Let us take you on a tour of the areas where light plays the most important role in setting your hotel centre stage.

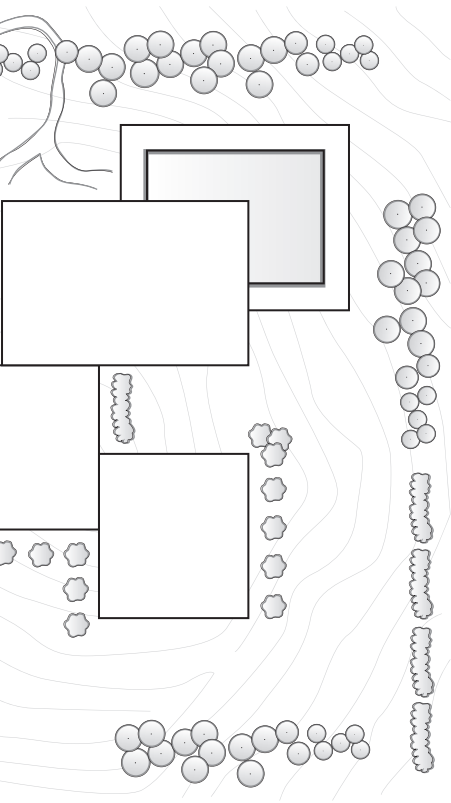

EXPERIENCING LIGHT

SPA AND DINING AREAS A hotel achieves distinctiveness through its unique service areas which offer the guest variety and an element of surprise. Unconventional lighting solutions fascinate and stimulate visitors and encourage them to revisit. Light in spa areas alleviates tensions and provides a calming and tranquil atmosphere, whereas, light in dining areas must ensure a memorable experience.

SEEING LIGHT

CORRIDORS AND FUNCTIONAL AREAS must be functionally illuminated in conformity with relevant standards, but also put across an emotional atmosphere. Where necessary, it must be possible to use a conference room in the evening as a room for staging special functions – this can be achieved by intelligently designed lighting. In functional areas, the emphasis is on efficient lighting for work which can be flexibly adapted to cater for various requirements.

FEELING LIGHT



Petra Maluck | Project Director Marriott International | Eschborn, D
former Project Manager ROBINSON

*“Light is a multitalented performer: it can follow moods or create moods,
it can lift us and immerse us in different rooms, feelings or realms.”*

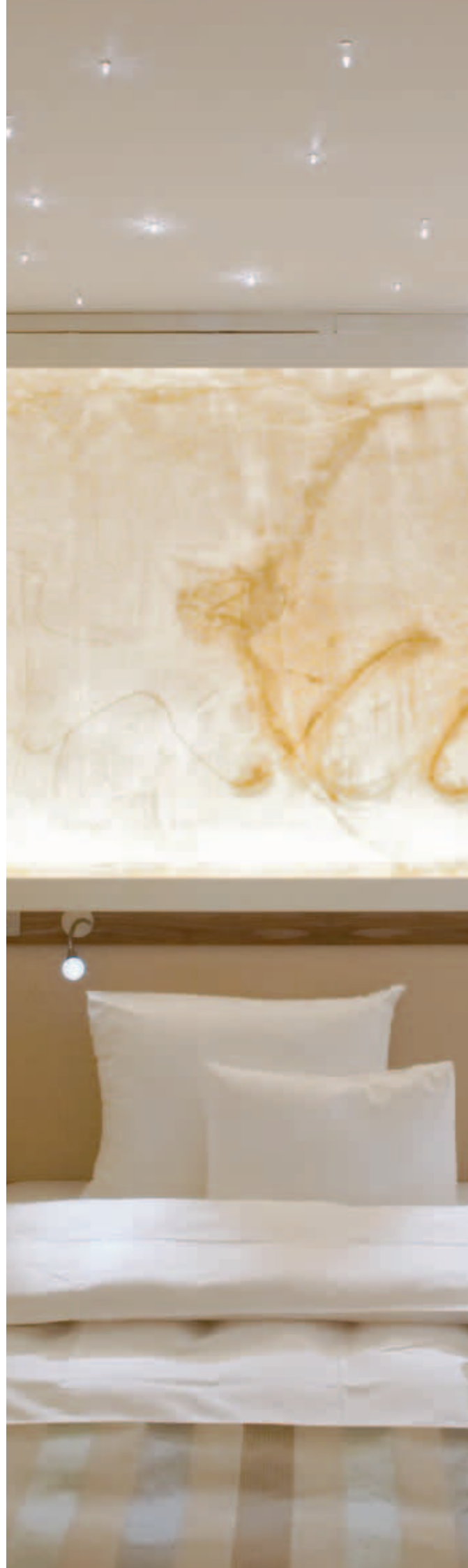



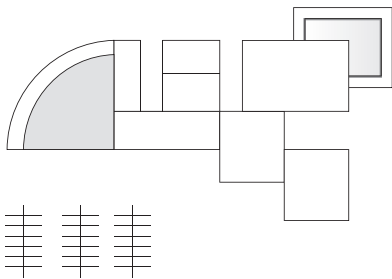

Feeling light | Hotel room and suite

Rooms that make guests feel good Home from home – hotel guests want to find their way around easily in an often unaccustomed environment. Harmonious, functional interior design and the right lighting pave the way to a stay with fond memories.

A multifunctional control unit which operates lights and blinds allows guests to individually adjust the lighting, and therefore the entire room effect, to suit their preferences. The ZBOX Lighting Management System and intuitive with easily-understandable CIRCLE operating points, allow individual adjustment of these all important feel-good factors. Guests feel that their personal preferences and demands are understood and catered for.



Hotel Carlton, St. Moritz / Switzerland Sensitive restored legacy luminaires, an integrated ZBOX lighting management system for easy call-up of lighting scenes, and customised signalling and call functions offer demanding hotel guests an exceptional level of convenience.



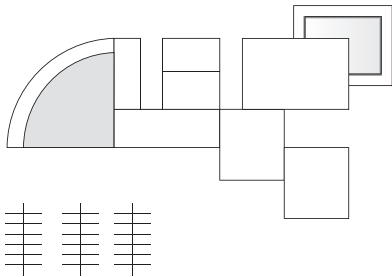

Feeling light | Private spa areas

In harmony with oneself Relaxing after a strenuous day at work. Bathing oases in private areas are becoming increasingly important because they perfectly combine individualism and intimacy. Unconventional room and lighting concepts convey a feel of luxury and uniqueness. Dynamic lighting sequences make relaxation something which can be consciously experienced.



Hotel Roomers, Member of Design Hotels Frankfurt / Germany Integrating the bath tub into the living area extends the requirements profile of the lighting concept. ZBOX lighting management is the ideal tool for delivering relaxation and wellness lighting scenes which can be called up at the press of a button.



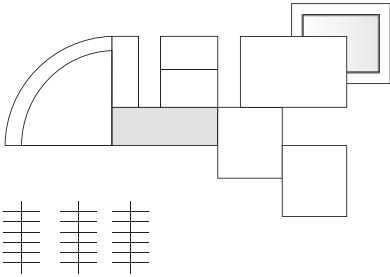

Feeling light | Entrance and reception areas

First impressions count Reception acts as a hotel's business card. This is where guests are welcomed and initially find their bearings. A friendly welcome and pleasant lighting, assist communicative processes. At the same time, appropriate lighting emphasises the architectural concept of the hotel and can make brand differentiation clear. Besides this, service personnel need functional task lighting in reception areas.

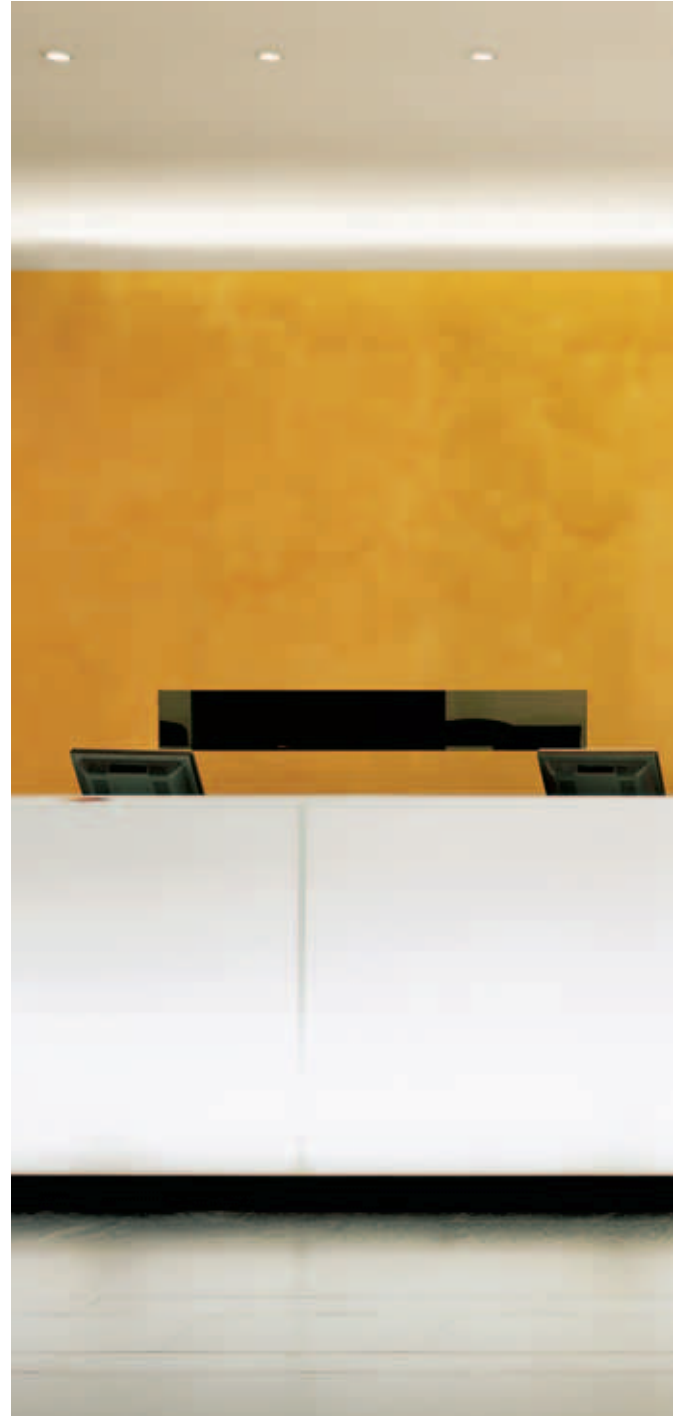

Hotel and Thermal Resort Merano/Italy Guests entering the hotel for the first time to check in are unconsciously guided by the backlit reception desk. In addition, a recurring "luminous field" element is incorporated to good effect. Directional light from downlights ensures adequate illuminance in conformity with relevant standards.



EXPERIENCING LIGHT



Mario Botta | Architect | Lugano, CH | www.botta.ch

"Light is a fundamental component, it is the element which creates space. I prefer working with natural light because it creates a sense of direction in a building. In my view, artificial lighting should support and supplement daylight."

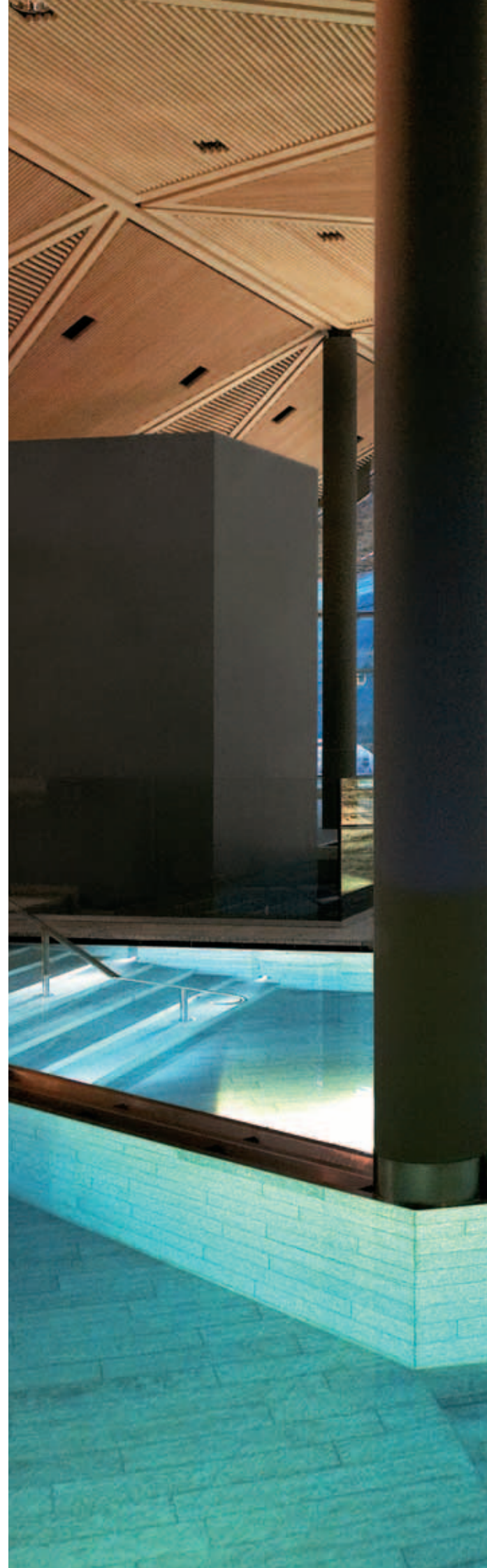





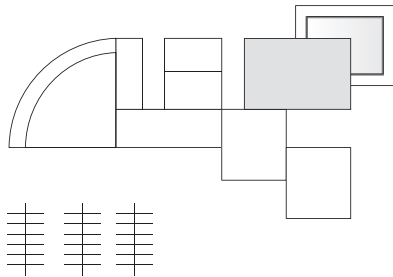

Experiencing light | Wellness and relaxation oases

Rooms that are in balance Increasing wellness and health awareness is also fuelling demand for high-quality treatment areas. Lighting which has a stimulating effect in sports and activity areas, and radiates beneficial warmth in spa and recreation areas, assists with many bodily functions. Luminaires with flexibly adjustable colour temperatures meet a variety of needs perfectly.



Lefay Resort & SPA Lake Garda, Gargnano / Italy The unique daylight on the hillsides of Lake Garda in northern Italy is the predominant light component in relaxation areas around the pool. Downlights and wallmounted luminaires with daylight-based control deep inside the room unobtrusively supplement the natural lighting scene.

Hotel Carlton, St. Moritz / Switzerland
The colonnade structure provided by the interior design is cleverly picked up and continued by luminaires recessed into the ceiling. This produces a corridor of light with maximum illuminance – this is both resource-conserving and effective.

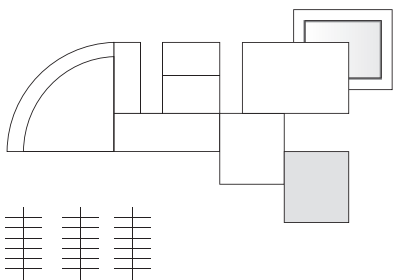

Experiencing light | Wellness and relaxation oases

Rooms that are in balance Holidaymakers and business travellers have equally exacting expectations when it comes to the quality of spa areas. These are places of harmony and calmness that are conducive to a pleasant holiday experience or provide a total contrast with the world of business and its associated stresses. Dynamic light, modelled on natural changes throughout the course of the day, has a positive effect on bio-rhythms, thus helping the body regenerate in a natural way.



East Sport, Hamburg / Germany Guests are impressed by the expressive illumination in the relaxation areas. The luminance levels of the wall-mounted luminaires simulate sunbeams and invite guests to linger and wind down.



Hotel Sonne, Mellau / Austria Linear luminaires asymmetrically installed in the ceiling cutouts provide an exceptionally cosy atmosphere by illuminating the wooden ceiling.

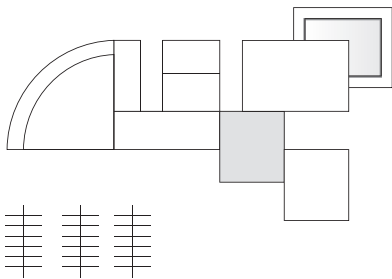

NHOW Hotel, Milan / Italy Decorative SCONFINE SFERA pendant luminaires provide an impressive lighting component as well as general lighting. Cove lighting along the peripheries of the lounge area rounds out the lighting concept softly but masterfully.



Experiencing light | Dining areas

Fresh & stylish Change is continually inevitable. An unmistakable, distinctive concept and design are particularly important aspects in the dining and entertainment area. Lighting in dining areas must emphasise the authenticity of the catering concept whether it be comfortably traditional or fine dining, cool or exotic. The desired effect will only be achieved if the light is right.

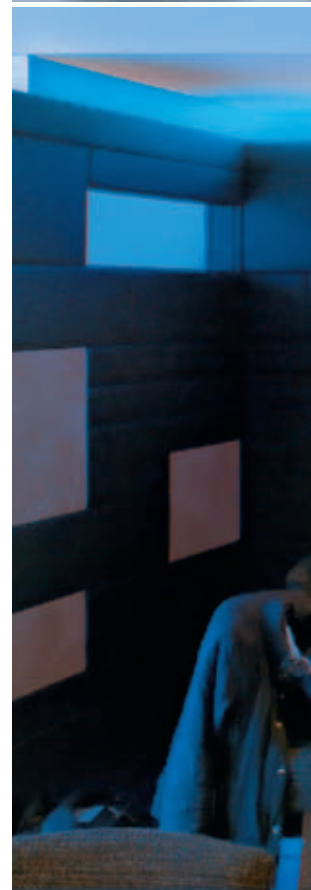

SCHRAMM'S Bar · Restaurant · Lounge, Au / Germany Built-in LED light lines produce coloured lighting effects. Ceiling and wall-mounted luminaires fitted with halogen lamps create perfect, pleasant lighting conditions on tables.



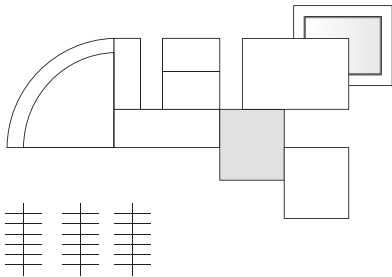

Experiencing light | Dining areas

Slow down Savouring relaxing moments, chatting with each other at a get-together or celebration in a relaxed atmosphere – appropriate lighting creates just the right ambience for such pleasures. It underlines the architecture and style of a restaurant and offers intimacy or cool elegance. Excellent colour rendition is particularly important in restaurant areas – the food should be a feast for the eyes, too.



Hotel Mama Shelter, Bar/Restaurant, Paris / France

Design by Philippe Starck. This cross between designer hotel and youth hostel stands on a site previously occupied by a multi-storey car park. Besides the graffiti on the ceiling – an homage to the building's past – industrial-style COPA pendant luminaires above the restaurant tables evoke the building's original use. Special halogen lamps produce pleasant pools of light on the distinctive tables.



SEEING LIGHT



Matteo Thun | studio thun & partners | Milan, I | www.matteothun.com

"Creating sustainable aesthetics – that is our aspiration. This includes comprehending the world as a holistic entity and thinking from the small to the big. This involves materiality, dimensions, proportions and defining how we look at the world and out of it, aspects which the lighting designer suggests to the architect."



Press Centre, Messe Frankfurt, F.a.M. / Germany

SCONFINE CUBO individual luminaires visualise the vibrant communication that sets the tone at the Messe Frankfurt Press Centre. Cove lighting integrated behind the suspended ceiling cleverly sets the granite wall apart from the rest of the room.





Event room, Hotel Sonne, Mellau / Austria Symmetrically arranged compact downlights allow the room to be used for a wide variety of different purposes. The stage area is lit by professional stage lighting.

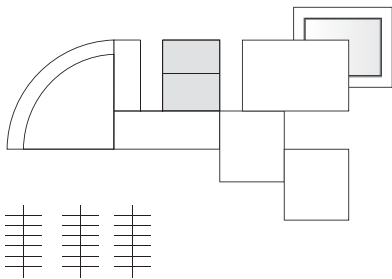

Seeing light | Multifunctional rooms

The “MICE” * Multifunctional rooms in hotels make heavy demands on lighting. Technologically perfect solutions when it comes to sound, acoustics, video, blinds and light are expected, in order to be able to cater flexibly for a variety of uses. It must be possible to variably and easily adapt the light to suit a particular use. Lighting control systems which make it possible to call up pre-set lighting scenes such as presentation, conference and banquet at the press of a button are definitely an advantage.

* Meeting, Incentive, Convention, Event



Hotel Clarion, Stockholm / Sweden MELLOW LIGHT creates perfect lighting conditions for working. 2LIGHT MINI downlights in the centre and at the peripheries of the room supplement the lighting solution when there are lectures and videos are shown. RGB luminaires produce coloured lighting effects deep inside the room.



Presentation

Coloured accent lighting and high illuminance levels draw attention to speakers.



Film screening

Dimmed direct light is confined to aisles and room peripheries.



Working

High illuminance levels and the ceiling brightened up by MELLOW LIGHT make working easier.

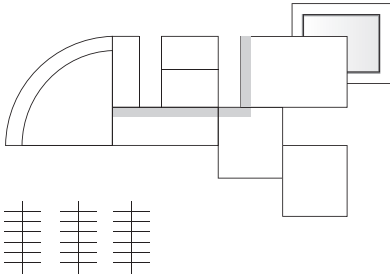

Seeing light | Corridors and functional areas

Providing a sense of direction The corridor leads the guest to his or her room. The right light helps to reduce the “tunnel effect” and make the route more inviting by adding lighting accents and rhythm. At the same time, strict emergency lighting regulations must also be met. Functional areas require individual lighting solutions which are tailored to suit the relevant visual tasks. The lighting in all workspaces must comply with national specifications.



Office areas

In work situations involving DSE workstations, care must be taken to ensure uniform glare-free lighting.



Hairdresser and beauty treatment areas

The use of light sources which have very good colour rendition goes hand in hand with the desire to offer guests a lighting experience with feel-good light.



**Hotel East, Member of Design Hotels,
Hamburg / Germany**

The extraordinary arrangement of downlights in the corridor coves creates areas with different lighting levels, with room numbers highlighted. Light opens up the more brightly lit areas of the corridor, thereby creating an impression of more generous space which guides guests towards their rooms.

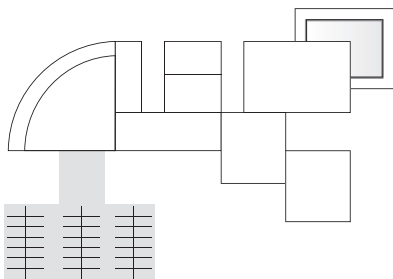

Seeing light | Circulation routes and technical equipment rooms

Light which is a recipe for functionality Access and parking areas give guests a first impression of the qualities of a hotel. Store rooms and technical equipment rooms need adequate amounts of light in order to be able to get stocks or analyse errors quickly. Service corridors and staff lifts must be lit so that employees can perform their duties quickly and safely.



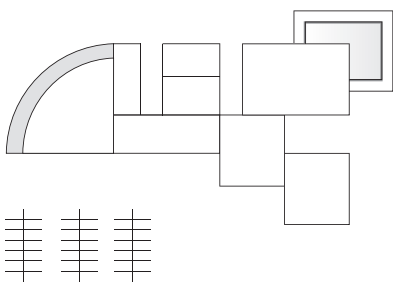

Seeing light | Facades and outdoor areas

Set centre stage A facade is a hotelier's advertising space. It must entice and captivate guests. Yet facade lighting must not disturb guests in their rooms. In some countries, e.g. Italy, there are also strict regulations in order to prevent light pollution.



Loisium Wine Museum, Langenlois /

Austria The wine museum is located in the middle of a vineyard – its architecture is something of a surprise in such a traditional setting. The individual lighting components of the interior lighting, as well as the downlights in the entrance area, all contribute towards a sensitive, atmospheric lighting scenario.

High-tech LED for hotel lighting

Energy efficient for more than 50,000 hours



TEMPURA



2LIGHT MINI



SUPERSYSTEM

Both functional and decorative Originally, the main emphasis may have been on lighting scenarios, accent lighting and orientation using defined colours and dynamic colour sequences but, thanks to progress achieved in terms of luminous efficiency and lighting quality, light emitting diodes are now increasingly being used for general lighting.



CIELOS LED



SCONFINE SFERA 170



SYSTEMLED

LED luminaires for decorative light LED light sources are particularly useful for creating dynamic lighting solutions because LEDs are easy to dim and switch. Colour-changing dynamic sequences are also very easily implemented because of the functionality of LEDs. Their extremely compact dimensions make them designers' and lighting designers' light source of choice.



MICROS LED



PANOS LED



CRAYON LED

Functional light LED downlights ensure brilliant general lighting in hotels, are architecturally flexible and produce a uniform vista. Combined with the advantages of highly efficient LED technology such as very compact dimensions and an extremely long service life, LED downlights are an attractive alternative to conventional light sources, especially in areas that are difficult to access.

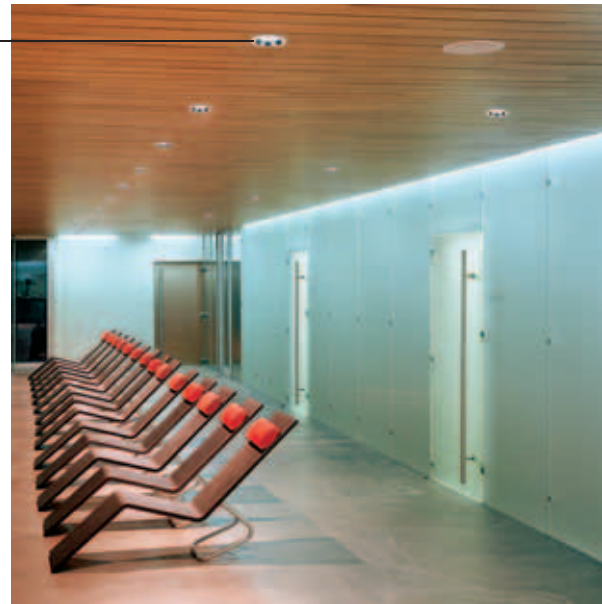

ONLITE ARTSIGN



ONLITE PURESIGN



ONLITE RESCLITE

Light for safety LED emergency and escape sign luminaires are impressively compact and maintenance-free. Thanks to maximum efficiency and perfect light distribution, a small number of luminaires is enough to provide emergency lighting in conformity with relevant standards. The luminaires can be installed at mounting heights ranging from 2.2 to 7 m.



ONLITE emergency lighting for hotels

Unobtrusive in everyday use – dependable in an emergency



Emergency lighting and designer luminaires Because of their construction, design and the light sources they use, decorative luminaires are not suitable for performing emergency lighting functions as a rule. Besides which, usually they do not satisfy the requirements that standards and regulations place on an emergency luminaire.

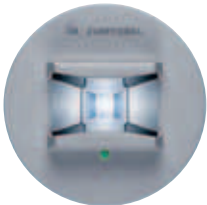

RESCLITE escape

LED emergency luminaire for escape route lighting according to EN 1838.

Maximum luminaire spacing:
up to 23 m > 1 lx



RESCLITE anti-panic

LED emergency luminaire for anti-panic lighting according to EN 1838.

Maximum room illumination:
up to 170 m² > 0,5 lx



RESCLITE spot

LED emergency luminaire for display lighting according to EN 1838.

Maximum display lighting:
Ø up to 3 m > 5 lx light

ONLITE RESCLITE – maximum safety with an inconspicuous design

RESCLITE LED emergency luminaires blend seamlessly into modern architecture thanks to their compact size and discreet design. Three different lens types offer maximum performance for every application. This means that a smaller number of luminaires is enough to ensure perfect visual conditions even in an emergency and to far exceed the requirements laid down by relevant standards. And the best thing about it: they are absolutely independent from general lighting and lighting management systems. The very low installed load of LED luminaires together with the reduced number of lighting points needed, make it possible to use very small power supply systems. This saves additional costs – and the scaled-down battery packs are environmentally friendly.



High-tech and design The extensive range of available ONLITE LED escape sign luminaires made of high-quality materials and featuring cutting edge design means that they blend into the architecture inconspicuously, unyet, in an exceptional way. Excellent LED lighting technology ensures uniform illumination of pictographs and hence an upmarket look as well as perfect orientation in an emergency. This luminaire range is complemented further by a comprehensive choice of power supply systems.



ONLITE PURESIGN
LED escape sign luminaire
Designed by EOOS



ONLITE ARTSIGN
LED escape sign luminaire
Designed by Matteo Thun



ONLITE central CPS
Emergency lighting systems with central power supply

Lighting management for hotels

Tailor-made lighting control systems for all areas



LUXMATE DIMLITE The new DIMLITE lighting control system is the ideal first step into the world of intelligent lighting control. DIMLITE makes it possible to cut energy consumption by up to 60 % while also improving the quality and flexibility of lighting. DIMLITE's built-in modules such as, presence-based lighting control using a presence detector, or daylight-based control, create scope for economies.



LUXMATE EMOTION The idea of easiest possible operation is emphasised in the compact LUXMATE EMOTION product range designed by Matteo Thun. It provides lighting management solutions which are otherwise only found in complicated building management systems. Simple, precise, and with a high degree of flexibility in terms of lighting group arrangement, this system is the ideal first step into the world of lighting control.



ZBOX The new ZBOX all-inclusive package allows hotel guests to personally choose the lighting atmosphere they desire, and to adjust it according to their needs – at the touch of a button. The central control unit, the ZBOX controller, is tuned to both the guest's lighting needs and the hotel operator's requirements: connectors for hotel card switches and door locking systems ensure a pleasant, inviting lighting scene as soon as the guest enters the room.



LUXMATE LITENET LITENET is a versatile lighting management system which caters for the increasing demand for comprehensive flexibility. It allows straightforward adaptation to room layout while also ensuring atmospheric room ambiances at optimal energy cost. ZBOX and LITENET can be linked together without any problem.



Examples of lighting solutions

Possible implementations and suggested products for setting the lighting stage in hotels

Hotel buildings comprise quite disparate areas. The tasks which the lighting in these rooms is expected to perform are diverse, but the lighting must work with the architecture as effectively as possible. An intuitive operating option that makes it possible to call up individual lighting scenes at the press of a button is indispensable in most of these areas. The following application matrix is laid out according to task and hotel area, and uses several examples of lighting solutions to illustrate possible implementations and product categories. Lighting solutions for other hotel areas can be found in the corresponding application brochures. Zumtobel's Lighting Solutions Consultants will be glad to help you and your specialist designer create your own customised lighting solution.

Task	Hotel areas														
	Facade	Entrance area	Lobby	Reception	Bar	Restaurant/catering areas	Corridor/circulation zones	Room - general	Room - desk	Room - bath/private spa	Spa	Relaxing	Fitness	Treatment areas	Multifunction rooms
Drawing and leading guests in (Outdoor and indoor areas)	■	■		■				■							
Creating structure	■		■			■	■								■
Presence in the room				■	■										
Evoking emotion / atmosphere			■		■	■		■		■	■	■	■		
Effects/the unexpected			■		■						■				
Intimacy					■	■			■	■	■	■	■		■
Relaxing/feeling at ease					■	■		■		■	■	■	■		
Hygiene / Make-up light									■		■		■	■	
Stimulating									■				■		■
Reading			■					■		■		■			
Orientation / Safety	■	■	■				■	■			■		■		■

Implementation	Lighting solution				Products			
High illuminance levels (Coloured) accents Using light to guide people Accentuating destinations/points of interest	 Light lines	 Lighting points	 Lighting installation	 Backlighting	 SLOTLIGHT	 MICROS LED	 SCONFINE SFERA	 CIELOS
Repeating lighting elements (ceiling, wall, floor) Repeating lighting points Highlighting important areas	 Light lines	 Cove lighting	 Backlighting	 Accent lighting (direct)	 SUPERSYSTEM	 VIVO	 CRAYON	 HILO
Dynamism Appropriate illuminance levels Defining space	 Wide-area light	 Volume/design	 Direct lighting	 Indirect lighting	 SCONFINE LINEA	 ALW	 RAY	 2LIGHT
Coloured light Dynamism Gentle lighting Defining space	 Wide-area light	 Cove lighting	 Lighting installation	 Accent lighting	 EMOTION	 LINO	 SCONFINE SFERA	 CIELOS
Lighting/architectural objects Dynamism Light combined with music, water, fragrance, material	 Lighting installation	 Volume/design	 Backlighting	 Projection	 CIELOS LED	 ALW	 EMPEDOS	 ARCOS
Low illuminance levels Sharply defined lighting spaces Warm light colours Good colour rendition	 Accent lighting (direct)	 Cove lighting			 SUPERSYSTEM	 GALILEO P. TERRA	 2LIGHT MINI	 HILO
Individual illuminance levels Warm light colours Good colour rendition Low-key lighting	 Accent lighting	 Cove lighting	 Backlighting	 Indirect lighting	 SUPERSYSTEM	 GALILEO P. TAVOLO	 2LIGHT MINI	 HILO
High illuminance levels Glare-free light Excellent colour rendition	 Make-up light	 Indirect lighting	 Direct lighting		 PANOS	 SLOTLIGHT	 MICROS	 CIELOS
Cool light colours High illuminance levels Glare-free light (guests lying in bed)	 Wide-area light	 Indirect lighting	 Direct lighting	 Wallwashing	 SUPERSYSTEM	 TECTON	 LIGHTTOOLS	 CIELOS
Defined lighting space Glare-free light	 Accent lighting (direct)	 Indirect lighting			 2LIGHT MINI	 ALVA	 MICROS LED	 PORSCHE P7111
Uniformity/balanced shadow detail Appropriate illuminance levels Using light to guide people Emergency lighting	 Wide-area light	 Light lines	 Direct lighting	 Emergency lighting	 RESCLITE ESCAPE	 LINARIA	 PANOS	 CIELOS

INDUSTRY AND ENGINEERING



SPORT AND LEISURE



Zumtobel is the internationally leading supplier of integral lighting solutions for a wide variety of applications in professional interior lighting:

- Industry and Engineering**
- Offices and Communication**
- Education and Science**
- Presentation and Retail**
- Hotel and Wellness**
- Art and Culture**
- Health and Care**
- Sport and Leisure**
- Transit Areas and Parking**
- Orientation and Safety**

TRANSIT AREAS AND PARKING



OFFICES AND COMMUNICATION



We provide unique customer benefit by integrating technology, design, emotion and energy efficiency. Under the Humanergy Balance concept, we combine the best possible ergonomic lighting quality for people's well-being with the responsible use of energy resources.

The company's own sales organisations in twenty countries, as well as, commercial agencies in fifty other countries form an international network of experts and design partners providing professional lighting consulting, design assistance and comprehensive services.

PRESENTATION AND RETAIL



HOTEL AND WELLNESS



ART AND CULTURE



HEALTH AND CARE



Corporate goal: We want to use light to create worlds of experience, make work easier and improve communications and safety while remaining fully aware of our responsibility to the environment.



Track and spots



Modular lighting systems



Down-/uplights



Recessed luminaires

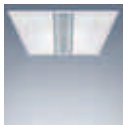

Surface-mounted and pendant luminaires

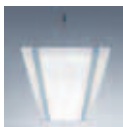

LED, task, wall and uplights



Continuous row and batten luminaires



High-bay luminaires



Luminaires with extra protection



Lighting management



Emergency lighting



Medical supply systems



United Kingdom

Zumtobel Lighting Ltd.
Unit 4 - The Argent Centre,
Pump Lane
Hayes/Middlesex UB3 3BL
T +44/(0)20 8589 1800
F +44/(0)20 8756 4800
M enquiries@zumtobel.com
www.zumtobel.co.uk

USA and Canada

Zumtobel Lighting Inc.
Location Highland
3300 Route 9W
Highland, New York 1258-2630
T +1/(0)845/691 62 62
F +1/(0)845/691 62 89
www.zumtobel.us
www.zumtobel.ca

Australia and New Zealand

Zumtobel Lighting Pty Ltd
333 Pacific Highway
North Sydney, NSW 2060
T +61/(2)8913 5000
F +61/(2)8913 5001
M info@zumtobel.com.au
www.zumtobel.com.au

China

Zumtobel Lighting China
Beijing Office
T5-2-152 Tayuan
Diplomatic Compound
No. 1 Xin Dong Road,
Chaoyang District
100600 Beijing
T +86/(10) 8532 3886
F +86/(10) 8532 3889
M admin@zumtobel.com.hk

Hong Kong

Zumtobel Lighting Hong Kong
Unit 319, Level 43,
Tower 1, Metroplaza,
223 Hing Fong Road,
Kwai Chung, N.T.
T +852/(0)2503 0466
F +852/(0)2503 0177
M admin@zumtobel.com.hk

India

Zumtobel Lighting GmbH
Branch Office India
Manipal Centre, S-605
Dickenson Road
560042 Bangalore
T +91 99 0017 0320
M pon.kumaresh@zumtobel.com

United Arab Emirates

Zumtobel Lighting GmbH (Branch)
Dubai Airport Free Zone,
Building 6W, B Block, 233
PO Box 54302
Dubai
T +971/(0)4 299 3530
F +971/(0)4 299 3531

Norway

Zumtobel Belysning
Pilestredet 75 C
0354 Oslo
Postbox 5829 Majorstuen
0308 Oslo
T +47 22 46 85 00
F +47 22 46 85 02
M firmapost@zumtobel.com
www.zumtobel.no

Sweden

Zumtobel Belysning
Birger Jarlsgatan 57
113 56 Stockholm
T +46 8 26 26 50
F +46 8 26 56 05
M info.se@zumtobel.com
www.zumtobel.se

Denmark

Light Makers AS
Indiavej 1
2100 København/Copenhagen
T +45 35 43 70 00
F +45 35 43 54 54
M lmsales@lightmakers.dk
www.lightmakers.dk

Czech Republic and Slovak Republic

Zumtobel Lighting s.r.o.
Jankovcova 2
Praha 7
170 00 Praha
T +420/(2) 66 782 200
F +420/(2) 66 782 201
M praha@zumtobel.com
www.zumtobel.cz

Poland

Zumtobel Licht GmbH Sp.z.o.o.
Przedstawicielstwo w Polsce
ul. Narbutta 46/48
02-541 Warszawa
T +48/(22) 856 7431
F +48/(22) 856 7432
www.zumtobel.pl

Russia

Zumtobel Lighting GmbH
Official Representative Office
Skakovaya Str. 17
Bld. No 1, Office 1104
125040 Moscow
T +7/(495) 945 36 33
F +7/(495) 945 16 94
www.zumtobel.ru

Slovenia and Croatia

Zumtobel Licht d.o.o.
Dunajska cesta 159
1000 Ljubljana
T +386/(1) 56 09 820
F +386/(1) 56 09 866
M bzslowenien@zumtobel.si
www.zumtobel.si

Headquarters

Zumtobel Lighting GmbH
Schweizer Strasse 30
Postfach 72
6851 Dornbirn, AUSTRIA
T +43/(0)5572/390-0
F +43/(0)5572/22 826

Zumtobel Licht GmbH
Grevensmarschstrasse 74-78
32657 Lemgo, GERMANY
T +49/(0)5261 212-0
F +49/(0)5261 212-7777
www.zumtobel.de

www.zumtobel.com

Art.-No. 04 900 421-UK 06/09
© Zumtobel Lighting GmbH.
Technical data was correct at time of going to press. We reserve the right to make technical changes without notice. Please contact your local sales office for further information. Printed on environmentally-friendly chlorine-free paper. Printed on Luxo Light.

LIGHT FOR HOTEL AND WELLNESS